

C-26 293

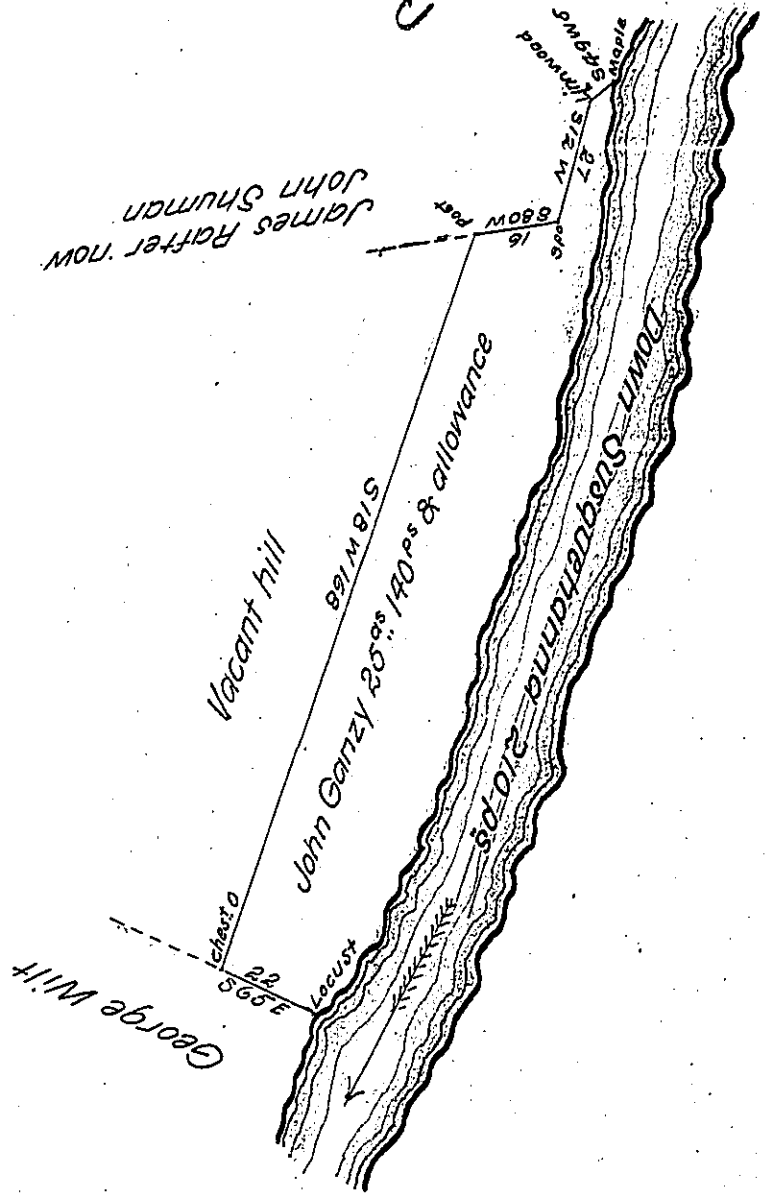

River Courses & Distances

- N 20 E 130
- N 12 E 45
- N 5 E 35

The Draught of a tract of land Situate in Greenwood Township Cum-  
 -berland County containing twenty five acres 140 perches & allowance Survey'd  
 13<sup>th</sup> April 1815 In pursuance of a Warrent granted to John Ganzy dated the 8<sup>th</sup>  
 August A.D. 1791

To Rich<sup>d</sup>. T. Leech Esquire  
 Surveyor General of Pennsylvania

Robt. Clark D.D.

IN TESTIMONY that the above is a copy of the original remaining on file in  
 the Department of Internal Affairs of Pennsylvania, made  
 conformably to an Act of Assembly approved the 16th day of  
 February, 1833, I have hereunto set my Hand and caused  
 the Seal of said Department to be affixed at Harrisburg,  
 this twenty second day of December 1904

*Loae R. Brown*  
 Secretary of Internal Affairs.